

**APPENDIX D-4**  
**Beneficiary Eligible Mitigation Action Certification**

## BENEFICIARY ELIGIBLE MITIGATION ACTION CERTIFICATION

---

Beneficiary Confederated Salish & Kootenai Tribes

Lead Agency Authorized to Act on Behalf of the Beneficiary Confederated Salish & Kootenai Tribes Tribal Air Quality Program  
*(Any authorized person with delegation of such authority to direct the Trustee delivered to the Trustee pursuant to a Delegation of Authority and Certificate of Incumbency)*

<b>Action Title:</b>	Truck Replacement and Electric Vehicle Charging Station
<b>Beneficiary's Project ID:</b>	CSKT-21-VW
<b>Funding Request No.</b>	<i>(sequential)</i> 1
<b>Request Type: (select one or more)</b>	<input type="checkbox"/> Reimbursement <span style="float: right;"><input checked="" type="checkbox"/> Advance</span> <input type="checkbox"/> Other (specify): _____
<b>Payment to be made to: (select one or more)</b>	<input checked="" type="checkbox"/> Beneficiary <input type="checkbox"/> Other (specify): _____
<b>Funding Request &amp; Direction (Attachment A)</b>	<input checked="" type="checkbox"/> Attached to this Certification <input type="checkbox"/> To be Provided Separately

### SUMMARY

<b>Eligible Mitigation Action</b>	<input checked="" type="checkbox"/> Appendix D-2 item (specify): <u>1, 6, 9</u>
<b>Action Type</b>	<input type="checkbox"/> Item 10 - DERA Option (5.2.12) (specify and attach DERA Proposal): _____
<b>Detailed Description of Mitigation Action Item Including Community and Air Quality Benefits (5.2.2):</b> See Addendum	
<b>Estimate of Anticipated NOx Reductions (5.2.3):</b> See Addendum	
<b>Identification of Governmental Entity Responsible for Reviewing and Auditing Expenditures of Eligible Mitigation Action Funds to Ensure Compliance with Applicable Law (5.2.7.1):</b> Office of Legal Counsel and the Finance Office of the he Confederated Salish & Kootenai Tribes	
<b>Describe how the Beneficiary will make documentation publicly available (5.2.7.2).</b> See Addendum	
<b>Describe any cost share requirement to be placed on each NOx source proposed to be mitigated (5.2.8).</b> Not applicable	
<b>Describe how the Beneficiary complied with subparagraph 4.2.8, related to notice to U.S. Government Agencies (5.2.9).</b> Confederated Salish & Kootenai Tribes were not contacted by these federal agencies within the specified time frame.	

If applicable, describe how the mitigation action will mitigate the impacts of NOx emissions on communities that have historically borne a disproportionate share of the adverse impacts of such emissions (5.2.10).  
Not applicable

**ATTACHMENTS**  
**(CHECK BOX IF ATTACHED)**

- |                                     |                     |   |
|-------------------------------------|---------------------|---|
| <input checked="" type="checkbox"/> | <b>Attachment A</b> | <b>Funding Request and Direction.</b>   |
| <input checked="" type="checkbox"/> | <b>Attachment B</b> | <b>Eligible Mitigation Action Management Plan Including Detailed Budget and Implementation and Expenditures Timeline (5.2.4).</b>   |
| <input checked="" type="checkbox"/> | <b>Attachment C</b> | <b>Detailed Plan for Reporting on Eligible Mitigation Action Implementation (5.2.11).</b>   |
| <input checked="" type="checkbox"/> | <b>Attachment D</b> | <b>Detailed cost estimates from selected or potential vendors for each proposed expenditure exceeding \$25,000 (5.2.6). [Attach only if project involves vendor expenditures exceeding \$25,000.]</b> |
| <input type="checkbox"/>            | <b>Attachment E</b> | <b>DERA Option (5.2.12). [Attach only if using DERA option.]</b>  |
| <input type="checkbox"/>            | <b>Attachment F</b> | <b>Attachment specifying amount of requested funding to be debited against each beneficiary's allocation (5.2.13). [Attach only if this is a joint application involving multiple beneficiaries.]</b> |

**CERTIFICATIONS**

**By submitting this application, the Lead Agency makes the following certifications:**

Confederated Salish & Kootenai Tribes

- 1. This application is submitted on behalf of Beneficiary \_\_\_\_\_, and the person executing this certification has authority to make this certification on behalf of the Lead Agency and Beneficiary, pursuant to the Certification for Beneficiary Status filed with the Court.**
- 2. Beneficiary requests and directs that the Trustee make the payments described in this application and Attachment A to this Form.**
- 3. This application contains all information and certifications required by Paragraph 5.2 of the Trust Agreement, and the Trustee may rely on this application, Attachment A, and related certifications in making disbursements of trust funds for the aforementioned Project ID.**
- 4. Any vendors were or will be selected in accordance with a jurisdiction's public contracting law as applicable. (5.2.5)**
- 5. Beneficiary will maintain and make publicly available all documentation submitted in**

**support of this funding request and all records supporting all expenditures of eligible mitigation action funds subject to applicable laws governing the publication of confidential business information and personally identifiable information. (5.2.7.2)**

**DATED:** October 15, 2020

Randy Ashley  
Air Quality Program Manager

**[NAME]**

**[TITLE]**

Confederated Salish & Kootenai Tribes Tribal Air Quality Program

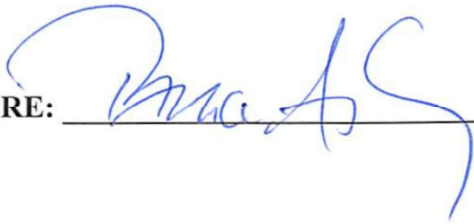
**SIGNATURE:** 

**[LEAD AGENCY]**

**for**

Confederated Salish & Kootenai Tribes

**[BENEFICIARY]**

**[SAMPLE ATTACHMENT B - USE OF THIS FORMAT IS NOT MANDATORY]**

**PROJECT MANAGEMENT PLAN**  
**PROJECT SCHEDULE AND MILESTONES**

Milestone	Date
Lead Agency Provides Notice of Availability of Mitigation Action Funds	6/29/2020
Project Sponsor Submits Proposal to Lead Agency	8/27/2020
Lead Agency Provides Written Approval of Project Sponsor's Proposal	8/27/2020
Lead Agency Incorporates Project Sponsor's Proposal into Mitigation Plan	8/28/2020
Trustee Acknowledges Receipt of Project Certification and Funding Direction	10/27/2020
Trustee Allocates Share of Funds for Approved Project	11/12/2020
Lead Agency Directs Funding (Advance Funded Projects)	11/26/2021
Project Sponsor Obtains Cost Share, Notifies or Certifies to Lead Agency	not applicable
Project Sponsor Enters into Contracts, Purchase Orders, etc. - Start	1/25/2021
Project Sponsor Enters into Contracts, Purchase Orders, etc. - Complete	1/25/2021
Project Installation(s) – Start	1/31/2001
Project Installation(s) – Complete	4/15/2021
Project Sponsor provides detailed invoices for all claimed project costs, documentation for emission reduction estimates, required certification documents to Lead Agency to support direction to Trustee for Payment (Reimbursement, Direct-to-Vendor) or final accounting (Forward Funded Projects)	-
Lead Agency completes review and certifies payment direction to Trustee (Reimbursement)	5/12/2021
Trustee Acknowledges Receipt of Direction for Payment(s) (Advance Funded, Reimbursement)	-
Project Sponsor Certifies Project Completion	5/12/2021
Lead Agency Reports Project Completion	5/12/2021

**PROJECT BUDGET**

Period of Performance: <u>Third Funding Cycle</u>				
Budget Category	Total Approved Budget	Share of Total Budget to be Funded by the Trust	Cost-Share, if applicable (Entity #1)	Cost-Share, if applicable (Entity #2)
1. Equipment Expenditure	\$ 395,145.50	\$ <b>395,145.50</b>	\$	\$
2. Contractor Support <i>(Provide List of Approved Contractors as Attachment with approved funding ceilings)</i>	\$	\$	\$	\$
3. Subrecipient Support <i>(Provide List of Approved Subrecipients or Grant Awardees as Attachment with approved funding ceilings)</i>	\$	\$	\$	\$
4. Administrative <sup>1</sup>	\$ 5202.16	\$ 5202.16	\$	\$
<b>Project Totals</b>	\$ 400,347.66	\$ <b>400,347.66</b>	\$	\$
<b>Percentage</b>	100 %	100 %	%	%

<sup>1</sup> Subject to Appendix D-2 15% administrative cap.

**PROJECTED TRUST ALLOCATIONS:**

	<b>2017</b>	<b>2018</b>	<b>2019</b>	<b>2020</b>	<b>2021</b>
1. Anticipated Annual Project Funding Request to be paid through the Trust	\$	\$	\$	\$ 400,348	\$
2. Anticipated Annual Cost Share	\$	\$	\$	\$ 0	\$
3. Anticipated Total Project Funding by Year (line 1 plus line 2)	\$	\$	\$	\$ 400,348	\$
4. Cumulative Trustee Payments Made to Date Against Cumulative Approved Beneficiary Allocation	\$	\$	\$	\$	\$
5. Current Beneficiary Project Funding to be paid through the Trust (line 1)	\$	\$	\$	\$	\$
6. Total Funding Allocated to for Beneficiary, inclusive of Current Action by Year (line 4 plus line 5)	\$	\$	\$	\$	\$
7. Beneficiary Share of Estimated Funds Remaining in Trust	\$	\$	\$	\$	\$
8. Net Beneficiary Funds Remaining in Trust, net of cumulative Beneficiary Funding Actions (line 7 minus line 6)	\$	\$	\$	\$	\$

## Addendum

### Detailed Description of Mitigation Action Item Including Community and Air Quality Benefits (5.2.2):

During the third funding cycle of the Volkswagen Settlement Environmental Mitigation Trust for Indian Tribes, the Confederated Salish & Kootenai Tribes will replace four eligible, government-owned diesel vehicles:

Year	Make	Model	Description	VIN	Class
2005	Ford	F-550	Used by Confederated Salish & Kootenai Tribes Forestry Department	1FDAW57P25EB64049	5
2001	Ford	F-550	Used by Salish Kootenai College	1FDAF57FX1ED01465	5
2002	Volvo	VNL	Used by Salish Kootenai College	4V4NC9TG52N323920	8
2002	Volvo	VNL	Used by Salish Kootenai College	4V4NC9TG92N323919	8

The eligible vehicles will be scrapped and replaced with a new, low-emission, diesel trucks. The Confederated Salish & Kootenai Tribes understands the term "scrapped" means to render inoperable and available for recycle, and, at minimum, to specifically cut a 3" or larger hole in the engine block of each vehicles and, for vehicles to be replaced as part of this project, to disable the chassis by cutting the vehicles' frame rails completely in half.

The Confederated Salish & Kootenai Tribes will acquire the following vehicles:

Eligible Mitigation Action Item	Description	Unit Cost	Quantity	Total
Large truck	2020 Volvo VNL	\$115,000	2	\$230,000
	Documentation fee	\$175	1	\$175
	Disable/disposal/hauling	\$542.50	1	\$542.50
Medium truck	2021 Ford F-550 with accessories	\$58,657	1	\$58,657
	Disable/disposal/hauling	\$542.50	1	\$542.50
Medium truck	2021 Ford F-550 with accessories	\$65,384	1	\$65,384
	Disable/disposal/hauling	\$542.50	1	\$542.50
<b>Vehicle Total</b>				<b>\$355,843.50</b>

The total cost of the replacement vehicles will be \$355,843.50. Costs have been obtained from qualified dealers (see Attachment D) and reflect delivery to Ronan, Montana and or Pablo, MT on the Flathead Reservation. The Ford F-550 totals represent a reduced governmental rate package totaling \$17,332.

The Tribes will also establish procure light-duty zero-emission vehicle supply equipment by establishing four (4) multi-port electric vehicle fast-charging stations, at the following locations: (1) Confederated Salish & Kootenai Tribal Headquarters, (2) Salish Kootenai College, (3) KwaTaqNuk Resort and Casino, and (4) Gray Wolf Peak Casino, all on the Flathead Reservation:

- 1) The **Confederated Salish & Kootenai Tribes complex** adjacent to Highway 93 in Pablo, MT. The complex property is well-lit, has sufficient electrical capacity for the charging station, and maintains 24/7 law and order service and 24/7 security inside and throughout the complex.
- 2) The **Salish Kootenai College** adjacent to Highway 93 in Pablo, MT. The college property is well-lit, has sufficient electrical capacity for the charging station, and maintains weekday desk service and 24/7 security inside and throughout the campus.
- 3) The **Confederated Salish & Kootenai Tribes KwaTaqNuk Resort and Casino** adjacent to Highway 93 in Polson, MT. The casino property is well-lit, has sufficient electrical capacity for the charging station, and maintains 24/7 desk service and 24/7 security inside and throughout the complex.
- 4) The **Confederated Salish & Kootenai Tribes Gray Wolf Peak Casino** complex adjacent to Highway 93 in Evaro, MT. The casino property is well-lit, has sufficient electrical capacity for the charging station, and maintains 24/7 desk service and 24/7 security inside and throughout the complex.

The electric vehicle charging stations will be part of a corridor project in Montana and other states to "electrify the West" with zero-emission charging stations available to the public to power their electric vehicles. The project may complement an initial electric vehicle charging station authorized in 2020 by the State of Montana, under the VW Settlement with placement on the reservation in Polson, MT, 69 miles north and another initial electric vehicle charging station in St. Ignatius, MT (42 miles north of Missoula, MT).

<b>Eligible Mitigation Action Item</b>	<b>Description</b>	<b>Unit Cost</b>	<b>Quantity</b>	<b>Total</b>
Light-duty zero-emission vehicle supply equipment	SemaConnect S6 Charging Station – Dual Pedestal	\$5,980	4	\$23,920
	Shipping and handling	\$920	1	\$920
	Annual network service fee	\$1,920	1	\$1,920
	Charging Station Electricity Development	\$3,135.50	4	\$12,542
			<b>ZEV Total</b>	<b>\$39,302</b>

The total cost of the light-duty zero-emission electric vehicle supply equipment is \$39,302.00.



<b>Administrative Expenditures</b>	<b>Description</b>	<b>Unit Cost</b>	<b>Quantity</b>	<b>Total</b>
Air Quality Staff	Program Manager	\$30.31/hour	120 hours	\$3,637.20
	Fringe benefits	26.48%	\$3,637.20	\$963
	Indirect Costs (per FY21 federal Indirect Cost Rate Agreement)	16.55%	\$3,637.20	\$601.96
<b>Admin Total</b>				<b>\$5,202.16</b>

The total cost of administrative expenditures is \$5,202.16. The Program Manager will be responsible for purchasing new vehicles, and managing the project from start to finish.

The overall project budget is as follows:

<b>Budget Item</b>	<b>Total</b>	
Vehicles	\$355,843.50	
Light-duty zero-emission vehicle supply equipment	\$39,302	
Administrative Expenditures	\$5,202.16	
	<b>\$400,347.66</b>	<b>Project Total</b>

The community and air quality benefits from the mitigation project will include energy efficiency and a reduction in pollution, including reduced emissions of NOx, reduced emission of noise, reduced fuel consumption, and reduced fuel costs.

### **Estimate of Anticipated NOx Reductions (5.2.3):**

The combined results for all groups and upgrades in the project are from the U.S. Environment Protection Agency Diesel Emissions Quantifier.<sup>1</sup> These results include the identified eligible Vehicles to be replaced in this Environmental Mitigation Action.

The Eligible Mitigation Actions undertaken by the Confederated Salish & Kootenai Tribes will result in a significant reduction in NOx emissions, other pollutants, and fuel consumption. Detailed data regarding Diesel Emissions Qualified (DEQ) standards of the U.S. Environmental Protection Agency and the Eligible Mitigation Action undertaken for vehicle replacement are as follows:

---

<sup>1</sup> Emissions from the electrical grid are not included in the results.

Vehicle	Annual Reduction in NOx Emissions	Lifetime Reduction in NOx Emissions
Ford F-550 Truck	95%	95%
Ford F-550 Truck	91.6%	91.6
Volvo T8 Truck	95%	95%
Volvo T8 Truck	95%	95%

**Describe how the Beneficiary will make documentation publicly available (5.2.7.2):**

The Confederated Salish & Kootenai Tribes will establish a webpage dedicated to the funding received from the VW Settlement Trust, which will include a link for members of the public to request additional information and documents related to the funding request and expenditures of funds. The Confederated Salish & Kootenai Tribes will endeavor to respond to such requests within ten (10) business days and, when documents are requested, will advise the individual within that timeframe of the procedure for reviewing such documents.

The Confederated Salish & Kootenai Tribes is committed to maintaining and making publicly available all documentation submitted in support of the Funding Request and all records supporting all expenditures of Eligible Mitigation Action funds, subject to applicable laws governing the publication of confidential business information and personally identifiable information.

## **Attachment C**

### **Detailed Plan for Reporting on Eligible Mitigation Action Implementation (5.2.11)**

The first semi-annual report will be submitted by May 12, 2021, no later than six months after the Confederated Salish & Kootenai Tribes receive their first disbursement of Trust Assets. Thereafter, semi-annual reporting will be done no later than January 30 (for the preceding six-month period of July 1 to December 31) and July 30 (for the preceding six-month period of January 1 to June 30) of each year, the Confederated Salish & Kootenai Tribes shall submit to the Trustee a semiannual report describing the progress implementing the Confederated Salish & Kootenai Tribes' project during the six-month period leading up to the reporting date (including a summary of all costs expended on the Eligible Mitigation Action through the reporting date).

## **Attachment D**

**Detailed cost estimates from selected or potential vendors for each proposed expenditure exceeding \$25,000 (5.2.6)**

Quotes for four vehicles the Confederated Salish & Kootenai Tribes intends to procure are attached.

These vehicles have NOT yet been procured;  
this is a cost estimate.

**Transport Equipment, Inc.**  
**9300 Inspiration Drive Missoula, MT 59808**  
**(406) 541-9097 1(800)-356-3547**

**SALES  
ORDER**

Name SALISH KOOTENAI COLLEGE Date 8/27/20  
Address 58138 US-93 Attn: \_\_\_\_\_

City/ State PABLO, MT Zip Code 59855 DOT/MC \_\_\_\_\_

Customer P.O.	Phone	F.O.B.
		<b>SAN DIEGO</b>

Qty.	Model Number	Description
2	2020 VOLVO VNR64T640 WHITE	Vin: 4V4WC9EH0LN255084
		4V4WC9EH2LN255085

Title Name \_\_\_\_\_

Trade Description: NO TRADE  
None

Warranties: FACTORY WARRANTY

24/250K ENGINE  
12/100K CHASSIS

Total Ea.	\$115,000.00
Total Units	2
Total Sales Price	\$230,000.00
Deposit	0
TRADE	\$0.00
Less Payoff	\$0.00
NET TRADE	\$0.00
Doc Fee	\$175.00
Total Due	\$230,175.00

DOES NOT INCLUDE F.E.T.

Terms: Contract Cash XX Other

Buyer agrees to purchase from seller the above described equipment for the prices listed on this agreement.

Any changes in specifications may result in a change in the sell price.

Dealer's Signature \_\_\_\_\_

NOTE: This proposal may be withdrawn by us if not accepted within \_N/A\_ days

Acceptance of Proposal The above prices, specifications and conditions are satisfactory and are hereby accepted. Payment will be made as outlined above.

Date of Acceptance: \_\_\_\_\_

Buyer's Signature \_\_\_\_\_

Buyer's Signature \_\_\_\_\_

Prices prevailing at the time of delivery to apply, and this offer shall be subject to availability at the time the order is placed.

**Important Please Read- Disclaimer of Warranties!**

Any warranties on the products sold hereby, are the warranties of the manufacturer of those products. TE hereby expressly disclaims all warranties, either expressed or implied including any implied warranty of merchantability or fitness for a particular purpose, and the Seller neither assumes nor authorizes any other person to assume for it any liability in connection with the sale of the vehicle. This disclaimer does not affect the manufacturer's warranty on this unit. I agree to hold Seller (Dealer) harmless against any and all claims for warranty except for those items specifically covered in writing in the warranty section of this sales order agreement which I have read, understand and agree to.

I have read the warranties and understand its contents

Buyer's Signature \_\_\_\_\_



8/28/2020

CSKT College

Prepared by:  
MaraLea McGill  
maralea@donaadsen.com  
406-676-4420

**2021 FORD F550 CHASSIS REG CAB DRW XL**  
**Oxford White**  
**Medium Earth Gray Cloth**  
**169" Wheelbase**  
**84" Cab to Axle**

## STANDARD EQUIPMENT

### MECHANICAL

- *Brakes – Power four-wheel Disc Brakes with Anti-Lock Brake System*
- *Transmission – Ten-Speed Automatic Transmission with Neutral Idle Selectable Drive Modes: Normal, Tow/Haul, Eco & Deep Sand/Snow & Slippery*
- *Electronic-Shift-On-the-Fly (ESOF) (4x4 only)*

### EXTERIOR

- *Bumper – front, black painted*
- *Fender vents – front*
- *Front License Plate Bracket*
- *Fuel Tank – 40 gallon aft axle (F-350 DRW/F-450/F-550)*
- *Glass – solar-tinted*
- *Grille – black painted*
- *Scuff plates – front, color-coordinated*
- *Splash Guards/Mud Flaps – Front (F-450/550 only)*
- *"Three Blink" Lane change signal*
- *Tow hooks – front (2)*
- *Trailer wiring – 7 wire harness w/relays, blunt cut & labeled*
- *Wheels*
  - *F-550 – 19.5" Argent Painted Steel*
  - *Manual Locking Hubs (4x4)*
- *Windshield Wipers – intermittent*

## **INTERIOR/COMFORT**

- *2.3" Productivity Screen in IP Cluster Instrumentation Center – Multifunction switch message center display with Ice Blue® Lighting*
- *12V Powerpoint, auxiliary*
- *Air conditioning – single-zone, manual*
- *Air conditioning vents – black w/chrome ring and knob*
- *Cabin Air Particulate Filter*
- *Door-trim – armrest/grab handle and reflector*
- *Floor covering – black, full length vinyl*
- *Mirror – rearview 11.5" day/night*
- *Outside Temperature Display*
- *Seat – Front, HD vinyl, 40/20/40 split bench w/center armrest, cupholder and storage (manual lumbar – driver's side)*
- *Steering – power*
- *Steering wheel – black urethane with tilt and telescoping steering wheel/column; includes three (3) button message control*
- *Sun visors – color-coordinated vinyl, driver w/pocket, passenger w/uncovered mirror insert with 6 inch overhead*
- *Upfitter switches – 6 located in Overhead Console*
- *Window – Rear, fixed*

## **SAFETY/SECURITY**

- *AdvanceTrac® with RSC® (Roll Stability Control™)*
- *Belt-Minder® (front safety belt reminder)*
- *Driver and passenger frontal airbag; passenger side deactivation switch*
- *Headlamps – Quad beam jewel effect halogen*
- *Lamps – Roof marker/clearance – LED*
- *Mirrors – manually telescoping two-way fold trailer tow with manual glass*
- *Safety Belts – w/height adjustment (front-outboard seating positions only)*
- *Safety Canopy® System (incl. side-curtain airbags)*
- *Stationary Elevated Idle Control (SEIC)*
- *SOS Post-Crash Alert System™*
- *Underhood service light*

## **FORD CO-PILOT 360 TECHNOLOGY**

- *AutoLamp – Auto On/Off Headlamps*



## **FUNCTIONAL**

- *Alternator*
  - *6.7L 4 Valve OHV Power Stroke® V8 Turbo Diesel – 220 AMP*
- *Audio – AM/FM stereo (four (4) speakers)*
- *Ford Pass Connect 4G Wi-Fi Modem*
  - *4G LTE Wi-Fi hotspot connects up to 10 devices*
  - *Remotely start, lock and unlock vehicle*
  - *Schedule specific times to remotely start vehicle*
  - *Locate parked vehicle*
  - *Check vehicle status*

*Note: Ford Telematics™ and Data Services Prep included for Fleet Only: FordPass™ Connect 4G Wi-Fi Modem provides data to support telematics and data services including but not limited to vehicle location, speed, idle time, fuel, vehicle diagnostics and maintenance alerts. Device enables telematics services through Ford or authorized providers. Activate at [www.fleet.ford.com](http://www.fleet.ford.com) or call 833-FCS-FORD or 833-327-3673.*

- *Stabilizer bars – front & rear*
- *SYNC®*
  - *Enhanced Voice Recognition Communication and Entertainment*
  - *911 Assist®*
  - *4.2" LCD Center Stack screen*
  - *AppLink®*
  - *Smart-Charging USB-C port – one (1)*

<b>2021 FORD F550 CHASSIS REG CAB 4X4 DRW</b>	\$ 43,970.00
<b>169" Wheelbase/84" CAB TO AXLE</b>	
<b>6.7L POWERSTROKE V8 TURBO DIESEL</b>	\$ 9,325.00
<b>TorqShift 10-Speed Automatic Transmissioin</b>	
Medium Earth Gray Cloth 40/20/40 Interior	\$ 100.00
Air Conditioning	
AM/FM/MP3/Clock	
4.10 Regular Axle	
Front License Plate Bracket	
Telescoping Trailer Tow Mirrors	
Power Equipment Group	\$ 865.00
Brake Controller	\$ 270.00
Cruise Control	\$ 235.00
Trans PTO Prov	
Utility Light System	\$ 160.00
AFT Axle Tank	
332 AMP Alternator	
Engine Block Heater	\$ 100.00
Installed Equipment (see attachment)	\$ 10,419.00
DESTINATION AND DELIVERY	\$ 1,695.00
SUB TOTAL	\$ 67,139.00
DISCOUNT	\$ (8,482.00)
TOTAL	\$ 58,657.00

**vehicle total, with accessories**



2400 Reo Drive  
 Flint, MI 48507  
 Sales Rep: Dave Chapman  
 Ph: (330) 347-4058  
 www.MonroeTruck.com

J.O. #

Quotation ID: 7SWB003271

Date: 8/27/2020

Valid thru: 9/26/2020

Terms: C.O.D.

Quoted by: Steve Broge

Ph/Fax: 608-329-8505 / 608-329-8521

**Quoted to:**

AADSEN FORD (DON) (ATTN: )

PO BOX L

64194 US HWY 93

RONAN, MT 59864

Ph: 406-676-4420 / Fax: 406-676-4426

Email:

**Model year should be 2021, to match vehicle**

**Chassis Information**

<b>Year:</b> 2020	<b>Make:</b> FORD	<b>Model:</b> F-550	<b>Chassis Color:</b>	<b>Cab Type:</b> REGULAR
<b>Single/Dual:</b> DRW	<b>CA:</b> 84.0	<b>CT:</b> -1.0	<b>Wheelbase:</b> 169.0	<b>Engine:</b> DIESEL
			<b>F.O. Number #:</b>	<b>Vin:</b>

**Notes:**

Monroe Truck Equipment, Inc. is pleased to offer the following quote for your review:

Description	Amount
132" MSS II SERVICE BODY	
- STEEL UNDERSTRUCTURE	
- 48.5" LOAD SPACE	
- A60 GALVANNEALED DIAMOND PLATE FLOOR	
- 18 GA OUTER DOOR SKIN, DOUBLE PANEL DOOR CONSTRUCTION	
- STAINLESS STEEL ROTARY PADDLE LATCHES & BOLT-ON DOOR HINGES	
- NITROGEN GAS STRUT DOOR HOLDERS	
- AUTOMOTIVE BUBBLE TYPE & MECHANICAL DOOR SEALS	
- ADJUSTABLE COMPARTMENT TRAYS/SHELVES	
- (1) SHELF IN EACH FRONT & 2ND FRONT, HORIZONTAL & REAR COMPARTMENTS	
- KNEE BRACED SLAM ACTION TAILGATE	
- SEAMLESS WHEELHOUSE PANEL W/ POLY CARBONATE FENDER FLARES	
- LED S/T/T LIGHTS RECESSED IN POOCHED STEP BUMPER	
- ACRYLIC E-COAT IMMERSION PRIMER SYSTEM & POWDER COATED	
- UNDERCOATED	
- REAR RECEIVER HITCH & TRAILER PLUG	
<b>Accessories total (for this vehicle)</b>	
<b>Quote Total:</b>	<b>\$10,214.00</b>

**Additional Options:**

Description	Amount	Add to quote?
BACKUP ALARM	\$121.00	Yes / No
INSTALL FACTORY BACKUP CAMERA	\$215.00	Yes / No

**Terms & Conditions**

- Terms are Due Upon Receipt unless prior credit arrangements are made at the time of order.
- Please note if chassis is furnished, it is as a convenience and terms are Net Due on Receipt of Chassis.
- State and Federal taxes will be added where applicable. **Out-of-state municipal entities may be subject to Wisconsin sales tax.**
- Restocking fees may be applicable for cancelled orders.
- MTE is not responsible or liable for equipment that does not meet local/state regulations if those laws are not made known at time of order.

By signing and accepting this quote, the customer agrees to the terms listed above and has confirmed that all chassis information listed above is accurate to chassis specs.

<b>Re-Assign (Required for all pool units):</b>	<input type="checkbox"/> Fleet	<input type="checkbox"/> Retail	<b>Customer P.O. Number:</b>	<b>Dealer Code:</b>	<b>Sourcewell Member Number:</b>
<b>MSO/MCO (ONLY check if legally required):</b>	<input type="checkbox"/> MCO	<input type="checkbox"/> MSO		74616	
<b>Customer Signature:</b>	<b>Date of Acceptance:</b>				







*MSSII*  
*MSSII Deluxe*  
*MSSII AL Series*



*98", 108" & 132" Body Lengths*



[www.monroetruck.com](http://www.monroetruck.com)



mssii

100%  
Powder  
Coat  
Finish

Nitrogen Gas Strut  
Door Holders



Slam Action Tailgate

L.E.D. FMVSS  
Compliant Lighting  
Package



Poly Carbonate Fender Flares

MTE "Pooched" Bumper with Black Powder Coat  
Finish. Bumper Mounting Plates are Reinforced for  
Optional Add-On Receiver Hitch Mounting.



Stainless Steel Bolt-On  
Block Hinges

### **MSSII Features and Benefits:**

- A60 Galvannealed Steel Throughout, Including the Load Space Floor.
- 18 Gauge Steel Outer Skin with Double Paneled Construction & Internal Reinforcement - Thickest & Strongest Doors in the Industry
- Large, Automotive-Quality, Bubble-Type Seal & Mechanical Seal Provide Dual Line of Defense Against Weather
- Primed & Powder Coated Steel Understructure
- Nitrogen Gas Strut Door Holders
- Stainless Steel Rotary Paddle Latches - Attractive Appearance with No Exposed Fasteners & Rust Resistant
- Poly Carbonate Fender Flares & Seamless Wheelhouse Panel - Fewer Places for Dirt & Moisture to Collect
- Stainless Steel Bolt-On Hinges Feature a Fully Concealed Pin that is Protected from the Elements & Provides Smooth, Reliable Operation
- Knee Braced Slam Action Tailgate
- MTE Pooched Bumper with Black Powder Coat Finish
- L.E.D. Stop/Turn/Tail Lights
- Acrylic E-Coat Immersion Primer System & Powder Coat White Finish Provides a Durable High Gloss Finish
- 6-Year Limited Warranty





## MSSII Deluxe



The MSSII Deluxe package includes all the features & benefits of the standard MSSII Service Body, PLUS...

- Top Paks with Bright Aluminum Lids
- Bright Aluminum Trim on Tailgate

Also available with an Optional Forklift-Loadable Ladder Rack



Nationwide Ship-Thru Available



## MSSII - AL Series



### MSSII - AL Series Features and Benefits:

- All Aluminum - Understructure Extruded Box Tube Construction
- Swing Doors - Compression T-Handle, Stainless Piano Hinges
- Heavy Duty Slam Action Tailgate
- Interlocking Extruded Flooring
- Fully Welded Construction
- Powder Coat Finish: White, Red or Black
- Poly Carbonate Fender Flares

- Brite Tread Plate Splash Guards on Front
- Pass Through Panel (Mid to Rear Compartment)
- 8" Bumper, Powder Coated Non-Skid Black, with (2) 6" L.E.D. Backup Lights & (5) Penny Lights
- L.E.D. Marker Lights
- 10-Year Limited Warranty



# MSSII Specifications

Model	Style	Axle	Overall Length	Overall Width	Floor Width	Body Height	No. of Side Compartments	Compartment Depth	Load Space Depth	Body Weight
MTE98	Standard	SRW	98"	77.8"	48.6"	40.1"	6	14.6"	23.8"	996 lbs.
MTE108	Standard	DRW	108"	91.8"	48.6"	40.1"	6	21.6"	23.8"	1,309 lbs.
MTE132	Standard	DRW	132"	91.8"	48.5"	40.1"	8	21.6"	23.8"	1,59 lbs.

MTE98

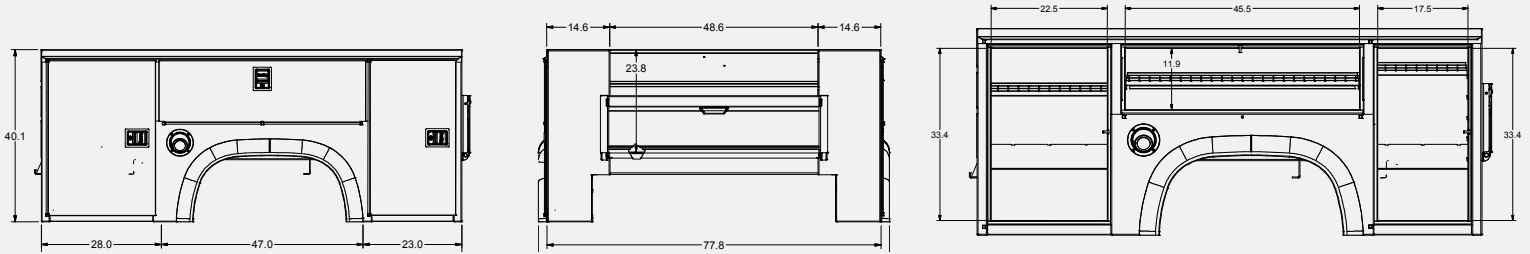

MTE108

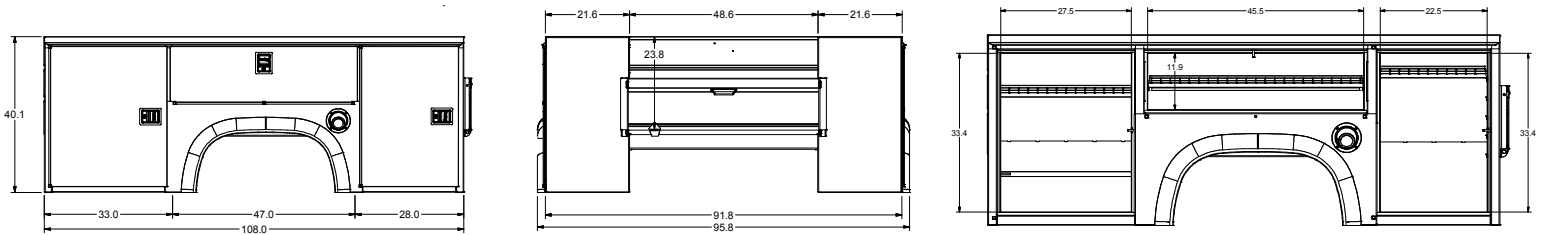

MTE132

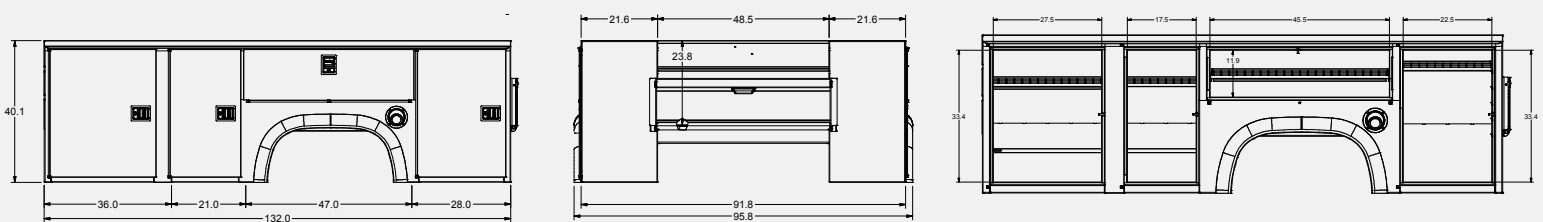



## MSSII Deluxe Specifications

Model	Style	Axle	Overall Length	Overall Width	Floor Width	Body Height	No. of Side Compartments	Compartment Depth	Load Space Depth	Body Weight
MTE98T	Steel Top Pack	SRW	98"	77.8"	48.7"	41.7"	6	14.8"	23.8"	1,07 lbs.
MTE108T	Steel Top Pack	DRW	108"	91.8"	48.7"	41.7"	6	21.8"	23.8"	1, lbs.
MTE132T	Steel Top Pack	DRW	132"	91.8"	48.7"	41.7"	8	21.8"	23.8"	1, lbs.
MTE98T	Alum Top Pack	SRW	98"	77.8"	48.7"	41.7"	6	14.8"	23.8"	988 lbs.
MTE108T	Alum Top Pack	DRW	108"	91.8"	48.7"	41.7"	6	21.8"	23.8"	1,395 lbs.
MTE132T	Alum Top Pack	DRW	132"	91.8"	48.7"	41.7"	8	21.8"	23.8"	lbs.

MTE98T

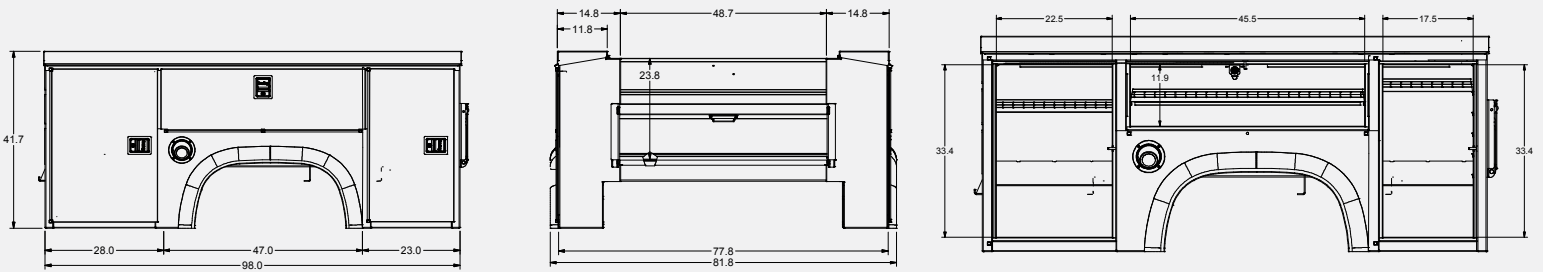

MTE108T

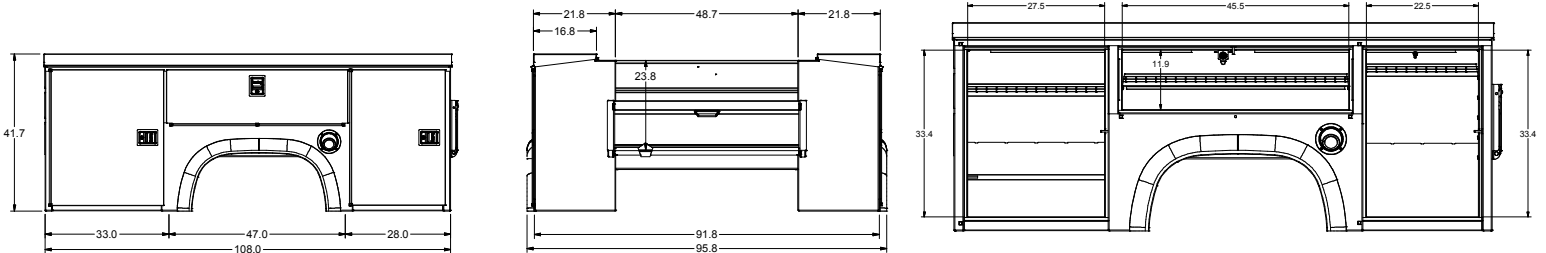

MTE132T

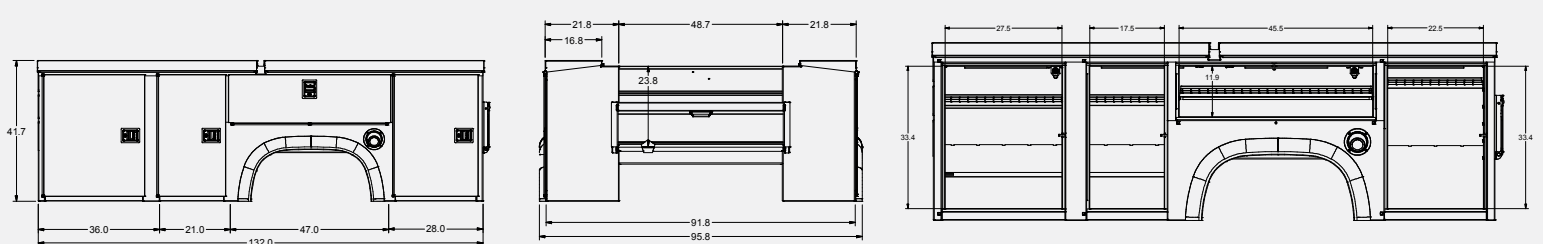

## *MSSII - AL Series Specifications*

Model	Style	Axle	Overall Length	Overall Width	Floor Width	Body Height	No. of Side Compartments	Compartment Depth	Load Space Depth	Body Weight
MTE98A	Aluminum	SRW	103.875"	80.188"	49.125"	40.125"	6	15.563"	24"	784 lbs.
MTE98A	Aluminum	DRW	103.813"	94.125"	54.125"	40.125"	6	20"	24"	895 lbs.
MTE108A	Aluminum	SRW	113.125"	80.375"	49.125"	40.125"	6	15.625"	24"	820 lbs.
MTE108A	Aluminum	DRW	113.125"	94.125"	54.125"	40.125"	6	20"	24"	912 lbs.
MTE132A	Aluminum	DRW	137.125"	94.125"	54.125"	40.125"	8	20"	24"	1,124 lbs.

MTE98A

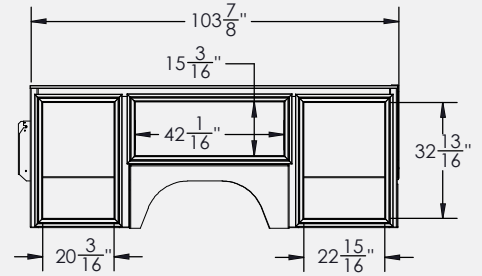
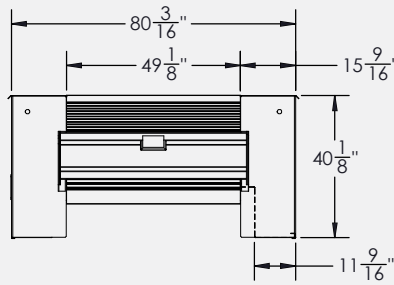
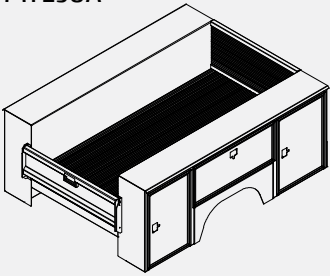

MTE108A

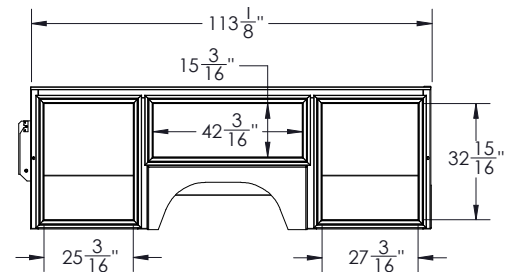
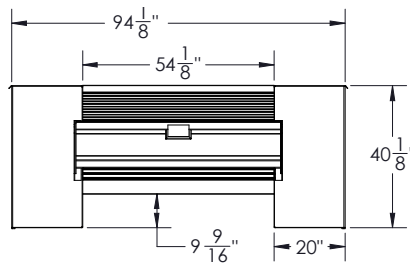
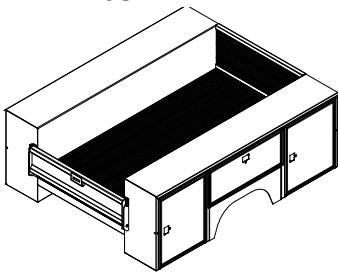

MTE132A

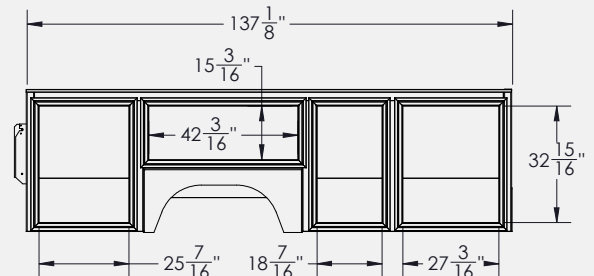
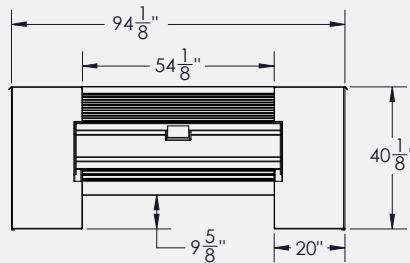
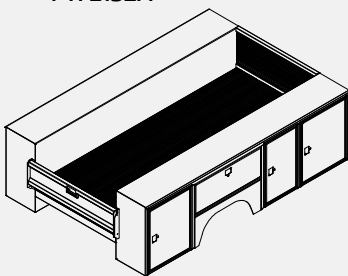

# Options



Liftgate & Bulkhead



Crane, Air Compressor, Engine & Auxillary Fuel Tank



Durabed Liner in Loadspace and Compartment Floors



MTE Ladder Rack



Tonneau Cover



Cab Rack with Strobe Light, Spot Light, Work Lights, Durabed Lining in Loadspace & E-Track



Top Packs



Welding Platform







## Seven Locations

**MONROE** 1051 W. 7th Street, Monroe, WI 53566 • 800.978.8785

**MARSHFIELD** 1601 E. 29th Street, Marshfield, WI 54449 • 800.882.1900

**DE PERE** 1151 W. Main Avenue, DePere, WI 54115 • 877.814.7605

**JOLIET** 812 Draper Avenue, Joliet, IL 60432 • 800.892.7052

**FLINT** 2400 Reo Drive, Flint, MI 48507 • 877.233.2030

**LOUISVILLE** 12001 Westport Rd, Louisville, KY 40245 • 800.978.8785

**LITCHFIELD - MONROE TOWMASTER**   
61381 US Hwy 12, Litchfield, MN 55355 • 888.878.8777



MTE Headquarters - Monroe, WI



**Nationwide Ship-Thru Available**

Visit Us Online at [www.monroetruck.com](http://www.monroetruck.com)



Monroe Truck Equipment  
1051 W. 7th Street  
Monroe, WI 53566



8/28/2020

CSKT WILDLAND

Prepared by:  
MaraLea McGill  
maralea@donaadsen.com  
406-676-4420

**2021 FORD F550 CHASSIS CREW CAB DRW XL**  
**Oxford White**  
**Medium Earth Gray Cloth**  
**179" Wheelbase**  
**60" Cab to Axle**

## STANDARD EQUIPMENT

### MECHANICAL

- *Brakes – Power four-wheel Disc Brakes with Anti-Lock Brake System*
- *Transmission – Ten-Speed Automatic Transmission with Neutral Idle Selectable Drive Modes: Normal, Tow/Haul, Eco & Deep Sand/Snow & Slippery*
- *Electronic-Shift-On-the-Fly (ESOF) (4x4 only)*

### EXTERIOR

- *Bumper – front, black painted*
- *Fender vents – front*
- *Front License Plate Bracket*
- *Fuel Tank – 40 gallon aft axle (F-350 DRW/F-450/F-550)*
- *Glass – solar-tinted*
- *Grille – black painted*
- *Scuff plates – front, color-coordinated*
- *Splash Guards/Mud Flaps – Front (F-450/550 only)*
- *"Three Blink" Lane change signal*
- *Tow hooks – front (2)*
- *Trailer wiring – 7 wire harness w/relays, blunt cut & labeled*
- *Wheels*
  - *F-550 – 19.5" Argent Painted Steel*
  - *Manual Locking Hubs (4x4)*
- *Windshield Wipers – intermittent*

## **INTERIOR/COMFORT**

- *2.3" Productivity Screen in IP Cluster Instrumentation Center – Multifunction switch message center display with Ice Blue® Lighting*
- *12V Powerpoint, auxiliary*
- *Air conditioning – single-zone, manual*
- *Air conditioning vents – black w/chrome ring and knob*
- *Cabin Air Particulate Filter*
- *Door-trim – armrest/grab handle and reflector*
- *Floor covering – black, full length vinyl*
- *Mirror – rearview 11.5" day/night*
- *Outside Temperature Display*
- *Seat – Front, HD vinyl, 40/20/40 split bench w/center armrest, cupholder and storage (manual lumbar – driver's side)*
- *Steering – power*
- *Steering wheel – black urethane with tilt and telescoping steering wheel/column; includes three (3) button message control*
- *Sun visors – color-coordinated vinyl, driver w/pocket, passenger w/uncovered mirror insert with 6 inch overhead*
- *Upfitter switches – 6 located in Overhead Console*
- *Window – Rear, fixed*

## **SAFETY/SECURITY**

- *AdvanceTrac® with RSC® (Roll Stability Control™)*
- *Belt-Minder® (front safety belt reminder)*
- *Driver and passenger frontal airbag; passenger side deactivation switch*
- *Headlamps – Quad beam jewel effect halogen*
- *Lamps – Roof marker/clearance – LED*
- *Mirrors – manually telescoping two-way fold trailer tow with manual glass*
- *Safety Belts – w/height adjustment (front-outboard seating positions only)*
- *Safety Canopy® System (incl. side-curtain airbags)*
- *Stationary Elevated Idle Control (SEIC)*
- *SOS Post-Crash Alert System™*
- *Underhood service light*

## **FORD CO-PILOT 360 TECHNOLOGY**

- *AutoLamp – Auto On/Off Headlamps*

## **FUNCTIONAL**

- *Alternator*
  - 6.7L 4 Valve OHV Power Stroke® V8 Turbo Diesel – 220 AMP
- *Audio – AM/FM stereo (four (4) speakers)*
- *Ford Pass Connect 4G Wi-Fi Modem*
  - 4G LTE Wi-Fi hotspot connects up to 10 devices
  - Remotely start, lock and unlock vehicle
  - Schedule specific times to remotely start vehicle
  - Locate parked vehicle
  - Check vehicle status

*Note: Ford Telematics™ and Data Services Prep included for Fleet Only: FordPass™ Connect 4G Wi-Fi Modem provides data to support telematics and data services including but not limited to vehicle location, speed, idle time, fuel, vehicle diagnostics and maintenance alerts. Device enables telematics services through Ford or authorized providers. Activate at [www.fleet.ford.com](http://www.fleet.ford.com) or call 833-FCS-FORD or 833-327-3673.*

- *Stabilizer bars – front & rear*
- *SYNC®*
  - Enhanced Voice Recognition Communication and Entertainment
  - 911 Assist®
  - 4.2" LCD Center Stack screen
  - AppLink®
  - Smart-Charging USB-C port – one (1)

<b>2021 FORD F550 CHASSIS CREW CAB 4X4 DRW</b>	\$ 47,540.00
<b>179" Wheelbase/60" CAB TO AXLE</b>	
<b>6.7L POWERSTROKE V8 TURBO DIESEL</b>	\$ 9,325.00
<b>TorqShift 10-Speed Automatic Transmissioin</b>	
Medium Earth Gray Cloth 40/20/40 Interior	\$ 315.00
Air Conditioning	
AM/FM/MP3/Clock	
4.10 Regular Axle	
Front License Plate Bracket	
Telescoping Trailer Tow Mirrors	
Power Equipment Group	\$ 1,075.00
Snow Plow Package	\$ 250.00
Brake Controller	\$ 270.00
Cruise Control	\$ 235.00
Trans PTO Prov	
Utility Light System	\$ 160.00
AFT Axle Tank	
332 AMP Alternator	
Engine Block Heater	\$ 100.00
Skid Plates	\$ 100.00
Installed Equipment (see attachment)	\$ 13,169.00
DESTINATION AND DELIVERY	\$ 1,695.00
SUB TOTAL	\$ 74,234.00
DISCOUNT	\$ (8,850.00)
TOTAL	\$ 65,384.00

**vehicle total, with accessories**





2400 Reo Drive  
 Flint, MI 48507  
 Sales Rep: Dave Chapman  
 Ph: (330) 347-4058  
 www.MonroeTruck.com

J.O. #

Quotation ID: 7SWB003274

Date: 8/27/2020

Valid thru: 9/26/2020

Terms: C.O.D.

Quoted by: Steve Broge

Ph/Fax: 608-329-8505 / 608-329-8521

**Quoted to:**

AADSEN FORD (DON) (ATTN: )

PO BOX L

64194 US HWY 93

RONAN, MT 59864

Ph: 406-676-4420 / Fax: 406-676-4426

Email:

**Chassis Information**

<b>Year:</b> 2020	<b>Make:</b> FORD	<b>Model:</b> F-450	<b>Chassis Color:</b>	<b>Cab Type:</b> CREW
<b>Single/Dual:</b> DRW	<b>CA:</b> 60.0	<b>CT:</b> -1.0	<b>Wheelbase:</b> 179.0	<b>Engine:</b> DIESEL
			<b>F.O. Number #:</b>	<b>Vin:</b>

**Notes:**

Monroe Truck Equipment, Inc. is pleased to offer the following quote for your review:

Description	Amount
9.5' FREEDOM RODEO PLATFORM - HD 1/8" TREADPLATE STEEL FLOOR - OUTSIDE RUB RAILS & STAKE POCKETS - GOOSENECK HITCH COMPARTMENT WITH TRAP DOOR & 2-5/16" BALL - LOUVERED BULKHEAD WITH LIGHTS & FULL WIDTH WINDOW - TREAD PLATE TAIL SKIRT - 3" FORMED CROSS SILLS, 4" STRUCTURAL CHANNEL LONG RAILS - UNDERCOATED - FMVSS - 108 LED LIGHTING - HIGH GLOSS BLACK POWDER COAT FINISH - (2) 7-WAY RV STYLE TRAILER RECEPTACLES - ICC BUMPER WITH 2" RECEIVER HITCH (14K)	
<b>Quote Total:</b>	<b>\$4,955.00</b>

**Additional Options:**

Description	Amount	Add to quote?
INSTALL FACTORY BACKUP CAMERA	\$215.00	Yes / No
BOSS 9'2" RAPID-TACH III VXT-PLOW BLADE COMPLETE KIT WITH WIRING	\$7,914.00.00	Yes / No

**Terms & Conditions**

- Terms are Due Upon Receipt unless prior credit arrangements are made at the time of order.
- Please note if chassis is furnished, it is as a convenience and terms are Net Due on Receipt of Chassis.
- State and Federal taxes will be added where applicable. **Out-of-state municipal entities may be subject to Wisconsin sales tax.**
- Restocking fees may be applicable for cancelled orders.
- MTE is not responsible or liable for equipment that does not meet local/state regulations if those laws are not made known at time of order.

By signing and accepting this quote, the customer agrees to the terms listed above and has confirmed that all chassis information listed above is accurate to chassis specs.

<b>Re-Assign (Required for all pool units):</b>	<input type="checkbox"/> Fleet	<input type="checkbox"/> Retail	<b>Customer P.O. Number:</b>	<b>Dealer Code:</b>	<b>Sourcewell Member Number:</b>
<b>MSO/MCO (ONLY check if legally required):</b>	<input type="checkbox"/> MCO	<input type="checkbox"/> MSO		74616	
<b>Customer Signature:</b>				<b>Date of Acceptance:</b>	





# Rodeo

Radius Tube Bulkhead



30,000# Goose Neck Hitch

Steel or Aluminum

10,000# Receiver Hitch / ICC Bumper



## Dimensional Data: Rodeo

Model	Body "L"	Body "W"	BH "H"	BH "W"	CA	Steel Wt.	Alum. Wt.
RD7S/F ~ SRW, 38" LS	84"	86" *	39"	82"	42"	680 lbs	425 lbs
RD7S/U ~ SRW, 42" LS	84"	86" *	39"	82"	42"	680 lbs	425 lbs
RD7S/G11 ~ SRW, 42" LS	84"	86" *	37"	82"	42"	680 lbs	425 lbs
RD8.5S/F ~ SRW, 38" LS	102"	86" *	39"	82"	56"	805 lbs	483 lbs
RD8.5S/U ~ SRW, 42" LS	102"	86" *	39"	82"	56"	805 lbs	483 lbs
RD8.5S/G11 ~ SRW, 42" LS	102"	86" *	37"	82"	56"	805 lbs	483 lbs
RD8.5D/F ~ DRW, 38" LS	102"	100" *	39"	82"	56"	880 lbs	528 lbs
RD8.5D/U ~ DRW, 42" LS	102"	100" *	39"	82"	56"	880 lbs	528 lbs
RD8.5D/G11 ~ DRW, 42" LS	102"	100" *	37"	82"	56"	880 lbs	528 lbs
RD9.5D ~ DRW, 34" LS	114"	96" *	39"/41"	82"	60"	992 lbs	595 lbs
RD11.5D ~ DRW, 34" LS	138"	96" *	39"/41"	82"	84"	1210 lbs	726 lbs

\* Includes pockets & rub rails || CA=Cab-To-Axle || BH=Bulkhead || LS=Long Sills || SRW=Single Rear Wheels || DRW=Dual Rear Wheels  
F= Ford || U=Universal GM > 2010 & Dodge || G11= GM 2011 > Current

## Standard Features

- \* 1/8" TP Deck
- \* Stake Pockets & Rub Rails
- \* Plug-In Wire Harness
- \* Recessed Lights, Body
- \* Recessed Lights, Bulkhead
- \* Recessed Tag Well
- \* GN-Hitch, 30,000#
- \* Clear View Window
- \* Asphalt Undercoating
- \* Powder Coat Finish

The stylish *Rodeo* bed has it all. The *Rodeo* offers that rugged custom look of a western bed, secure pockets & rub rails, 30,000# goose neck hitch, our *Rodeo* bulkhead with a full unobstructed rear window, recessed lights, full stop/tail/turn bulkhead lights and a tough but stylish radius tube frame. Standard is a PPG Powder Coat black finish to stand up to the elements. All that style and the quality you have grown to expect from Freedom Truck Beds.



**MONROE TRUCK EQUIPMENT, INC.**  
 1051 W. 7th Street • Monroe, WI 53566  
 800-978-8785 • 608-328-8127  
[www.monroetruck.com](http://www.monroetruck.com)



# Electric Vehicle Charging Station Order Form

Prepared By	Eric Smith	Quote Name	Confederated Salish & Kootenai Tribes- Qty 4 L2 Stations
Email	eric.smith@semaconnect.com	Quote Number	Q-12696
Phone	425-429-3343	Created Date	9/22/2020
Bill To Name	Confederated Salish & Kootenai Tribes	Phone	(406) 675-2700
Contact Name	Randy Ashley	Email	randall.ashley@cstkt.org
Bill To	PO Box 275 Pablo, MT 59855 US	Ship To	PO Box 275 Pablo, MT 59855

SemaConnect is pleased to extend this offer of Electric Vehicle Charging Station products and services. By signing this document you are committing to order the charging station solution as defined below.

### Product and Services Description

- SemaConnect Commercial-Grade Smart EV Charging Station(s) with Mounting Device(s)
- Full Service Program includes:
  - Network Service Program: Cloud-based management software, 1-800 driver support, dedicated cellular data communications and 24x7x365 state-of-health monitoring.
  - Warranty Program: Full Replacement Service with no repair cycle

Product	List Price	Discount \$	Quantity	Subtotal
SemaConnect S6 Charging Stations w/ One Year Full Service - Dual Pedestal	\$7,180.00	\$1,200.00	4.00	\$23,920.00

**Please Note:** Shipping and Handling is an estimate. Final cost will be provided after your order ships. Sales tax will be charged in select states based on the current rate and the ship to address unless a sales tax exemption form is received prior to shipping.

Total Price	\$23,920.00
Shipping and Handling	\$920.00
Grand Total	\$24,840.00

### Network Service Fees

Network Service Fees will begin after Full Service Program is complete and will be billed annually.

Yearly Network Service Fee	\$1,920
Delivery Schedule	Delivery within 3 week(s) of placing the Order

This signed document shall serve as a Purchase Order for the proposed project

Price does not include exact shipping fees or sales tax  
Quoted price is valid for 30 days from Created Date

- Shipment within 60 days of Order: Invoice for 100% of project price upon shipment with Net 30 day terms
- Shipment 60 days or greater of Order: Invoice for 25% upon order placement, 75% upon shipment with Net 30 day terms

### Accepted by:

Name  
Title  
Signature  
Date



# Electric Vehicle Charging Station Order Form

Installation Property Information - Must be filled in for order to be processed

Property Name:

Property Contact Name:

Property Address:

Property Contact Phone:

Property Contact Email:



## SemaConnect Commercial & Public Product Line Series 6 EV Charging Solution

The SemaConnect 6 Series EV Charging Station comes with your choice of mounting device (single pedestal, dual pedestal, or wall mount) and Full Service 1, 3 and 5 packages that include one, three, or five year Network Service and Full Replacement Warranty Coverage.



Single Pedestal

### Full Service 1

**\$3,590**  
SC6-Full1-P  
Dual Unit-2X

### Full Service 3

**\$4,630**  
SC6-Full1-DP  
Dual Unit-2X

### Full Service 5

**\$5,550**  
SC6-Full1-W  
Dual Unit-2X

Option: SemaConnect's **Cable Management System** for single pedestal, dual pedestal, or dual wall-mount configuration.



Single Pedestal  
**\$600**  
SC-CMS-1



Dual Pedestal  
**\$600**  
SC-CMS-2

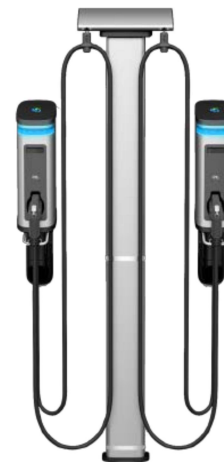

Dual Wall Mount  
**\$600**  
SC-CMS-2

Option: **Annual Full Replacement Service Contract**

**\$400**

Option: **Network Service Program**

SC6-FRS

**\$240**

SC6-NSP

**Full Service Packages** – SemaConnect's Full Service Packages include both the EV charging station product and supporting services to make it easy for commercial properties to install, operate and maintain the EV charging amenity that provides an exceptional experience for EV drivers with minimal disruption to the property management staff. The packages include:

#### Smart EV Charging Station

- Sleek compact "no assembly required" head unit with rugged extruded aluminum enclosure
- Dedicated user interface with "At-A-Glance" LED status light
- Your choice of mounting device – Pedestal, Dual Pedestal or Wall/Pole-Mount

#### Network Services, Pre-paid

- Cloud-Based Station Management Software
- Configure your pricing and access policy
- Generate usage & sustainability
- Wireless "All-Gateway" data communications, 24x7x365 1-800# driver support and health monitoring

#### Full Replacement Warranty, Pre-paid

- Best in-class warranty with no repair cycle or contractor visits required
- Replacement unit is delivered to your property, swapped for original unit and becomes operational unit

## SemaConnect Smart EV Charging Solutions



### Why Electric Vehicle Charging Stations

- Highly visible green amenity for commercial real estate properties
- Complement USGBC LEED sustainability programs
- EV drivers want to charge at home, work, and on the road

### Smart/Networked EV Charging for Station Owners

- Easily control station access
- Easily limit use time to ensure parking turnover and station sharing
- Easily implement and modify pricing programs

### Smart/Networked EV Charging for Drivers

- View real time station availability on mobile apps
- Easily start and pay for charging sessions via credit cards, RFID cards, and mobile apps

### Why SemaConnect

- Leading provider to Class A commercial properties in North America
- Partnerships and interoperability with leading EV driver programs:
  - PlugShare – Leading station locator app in North America
- SemaConnect is the flagship “Pay with PlugShare” provider
  - EVgo – Leading EV driver service provider in North America
- SemaConnect is the preferred supplier and interoperability partner
- Full Replacement Service policy – Best-in-industry warranty program
- Compact “no assembly required” head unit for easy installation
- Sleek, visually appealing form factor complements your Class A property and parking design
- Backlit LED screen- Staff and drivers read station status at a glance
- Dedicated “all-gateway” cellular data communication for maximum reliability
- Leading EV charging education partner for commercial real estate
  - Lunch and learns available for architects, engineers, and commercial properties
  - Monthly USGBC-endorsed webinars

### Comprehensive Cloud-Based Station Management Software

#### Cloud-based Software for EV Drivers

##### Free-of-charge driver account

- Manage payment options and set up notifications
- Mobile App- View station locations, real-time availability, and pricing/access policy information
- Sustainability Reports- Drivers can view reports with their carbon offset and fuel displacement

##### Five Ways to Pay

- Pay with RFID smart card, mobile app, mobile website, 1-800 number, or PlugShare app
- Interoperability- Pay with PlugShare and ChargeHub, or find stations on Google Maps

#### Cloud-Based Software for Station Owners

##### Software Configured to Your Needs

- Pricing- Three customizable pricing formats (time-of-use, duration, and kWh)
- Access- Set up member groups with individual pricing or access controls on each station

##### Management Reporting

- Report Generation- Generate usage reports by hierarchal grouping (organization, property address, individual station) and calendar time window
- Report Type- Generate a wide variety of reports including transaction history, energy provided, electricity cost, driver revenue generated, utilization